

# CONNECTOR MANUFACTURERS

**TOPTEK®**  
HARDWARE ELECTRONIC MANUFACTURER



## Female Header 2.54mm 2 Row H=8.5mm SMT Right Angle

**Specifications**  
 Current Rate: 3 AMP  
 Insulation Resistance: 1000MΩ Min.  
 Contact Resistance: 20mΩ Max.  
 Dielectric Voltage: 1000V AC for one minute  
 Operation Temperature: -40°C to +105°C

**Material**  
 Insulator: Hi-Temp. Thermoplastic, UL 94V-0  
 Terminal: Copper Alloy  
 Plating: Gold Plated

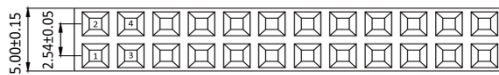

Recommended P.C.B. Layout (TOP Side)  
(PCB BOARD TOLERANCE ±0.05)

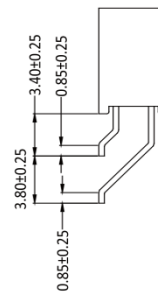
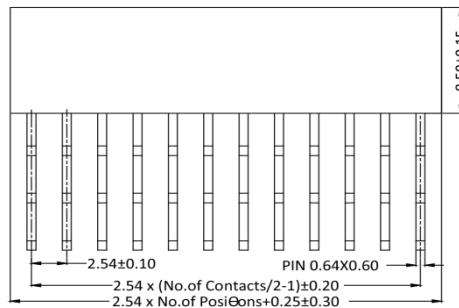

Part No.: PS1MR85-2XX-X

### ORDER INFORMATION

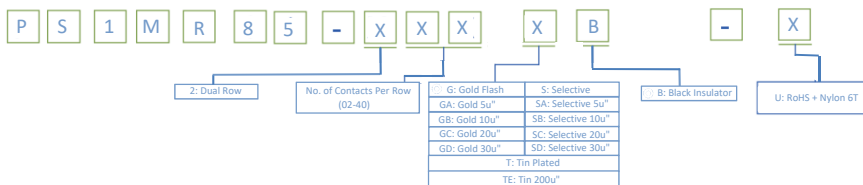

☺: Standard Recommend

